

Temporary Construction Area
Campus Traffic

* WATCH FOR FLAGMEN AND SIGNAGE
ESPECIALLY DURING START OF
SCHOOL WEEK.

NO ACCESS
AREA OF CLOSURE
TO BEGIN MAY 28,
2025 AND
CONCLUDE JUNE 15,
2027

CONTRACTOR
PARKING, STORAGE
AND LAYDOWN TO
BE WITHIN SITE
FENCING

UCR LOT B TO
REMAIN OPEN
FROM CHASE RD
AND BERGER
CIRCLE

LOT B TO REMAIN
OPEN (ACCESS
FROM COOK ST.
AND BERGER DR.

ELEC/TELECOM
SINGLE LANE
CLOSURE
1/12/2026 -
1/29/2026

CSUSB PARKING
AREA FOR
SERVICE CARTS
AND VEHICLES

SITE
ACCESS
GATE

LOT A FULL
ACCESS

RE-ROUTE
TEMPORARY ONE
WAY ROAD
CLOSURE SIGN



CONSTRUCTION SITE FOR
STUDENT SERVICES BLDG

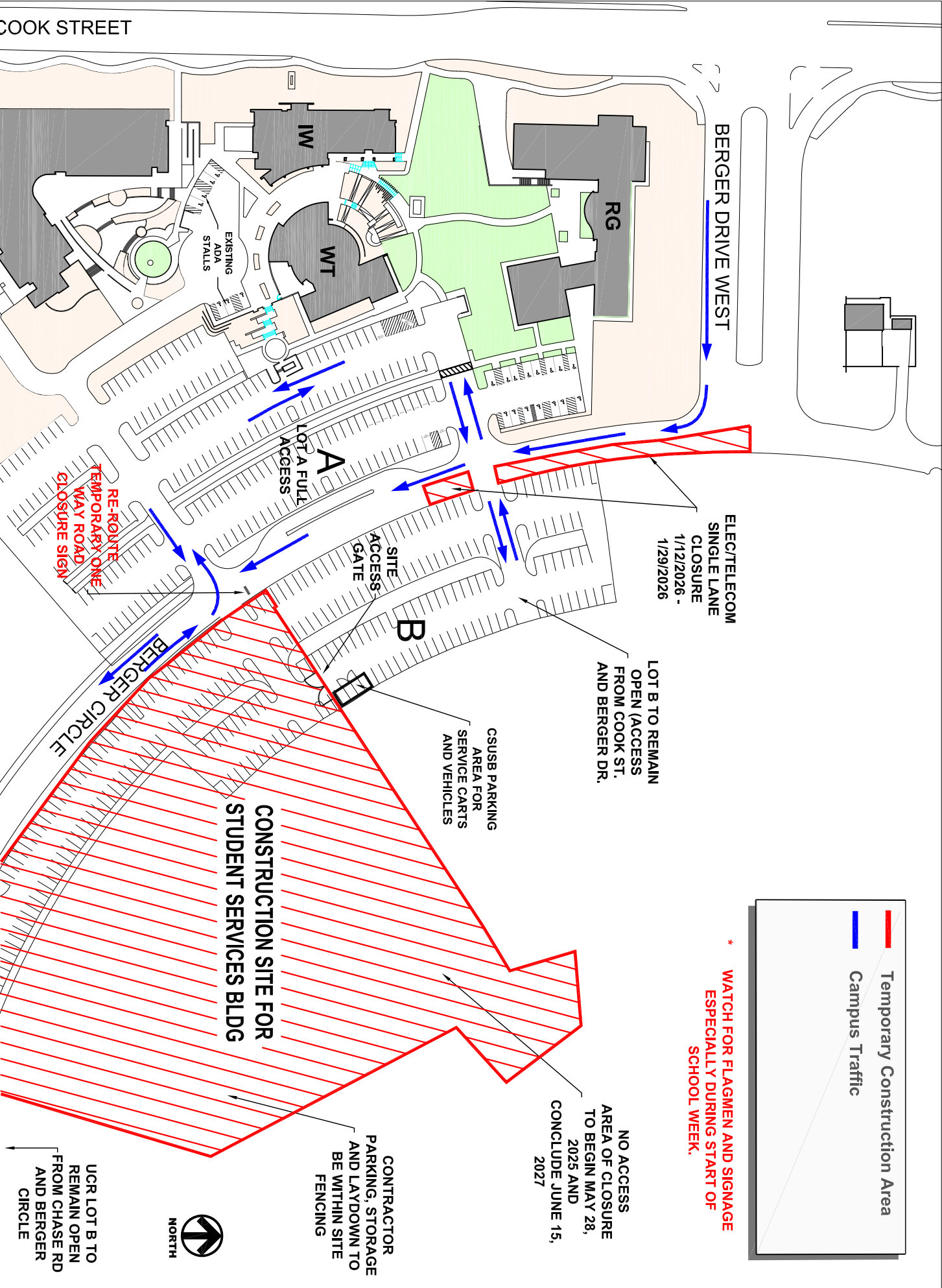

PDC UTILITY PROJECT PHASE 3
JANUARY 12, 2026 - JANUARY 29, 2026